

## POST MOUNT BRACKETS FOR MINI AND SMALL "M" CARRIAGES

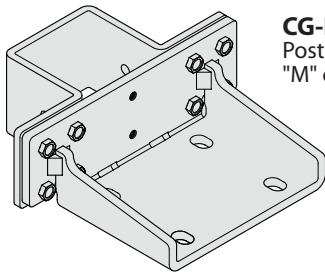

### CG-PBSM

Post mount bracket for the mini and small "M" carriages. Use with 4" square tubing.

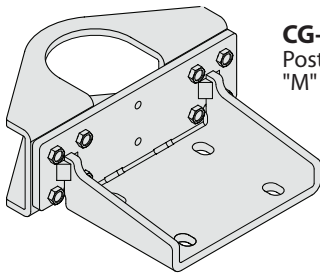
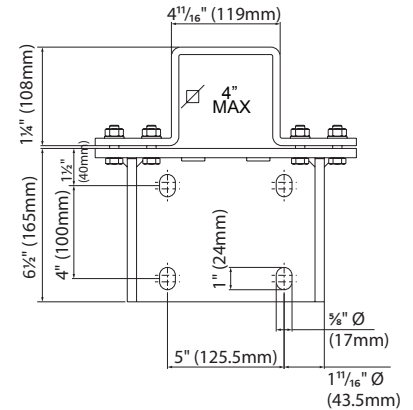
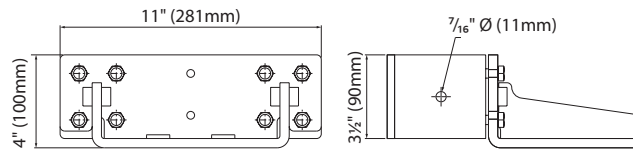

### CG-PBRM

Post mount bracket for the mini and small "M" carriages. Use with 4" round tubing.

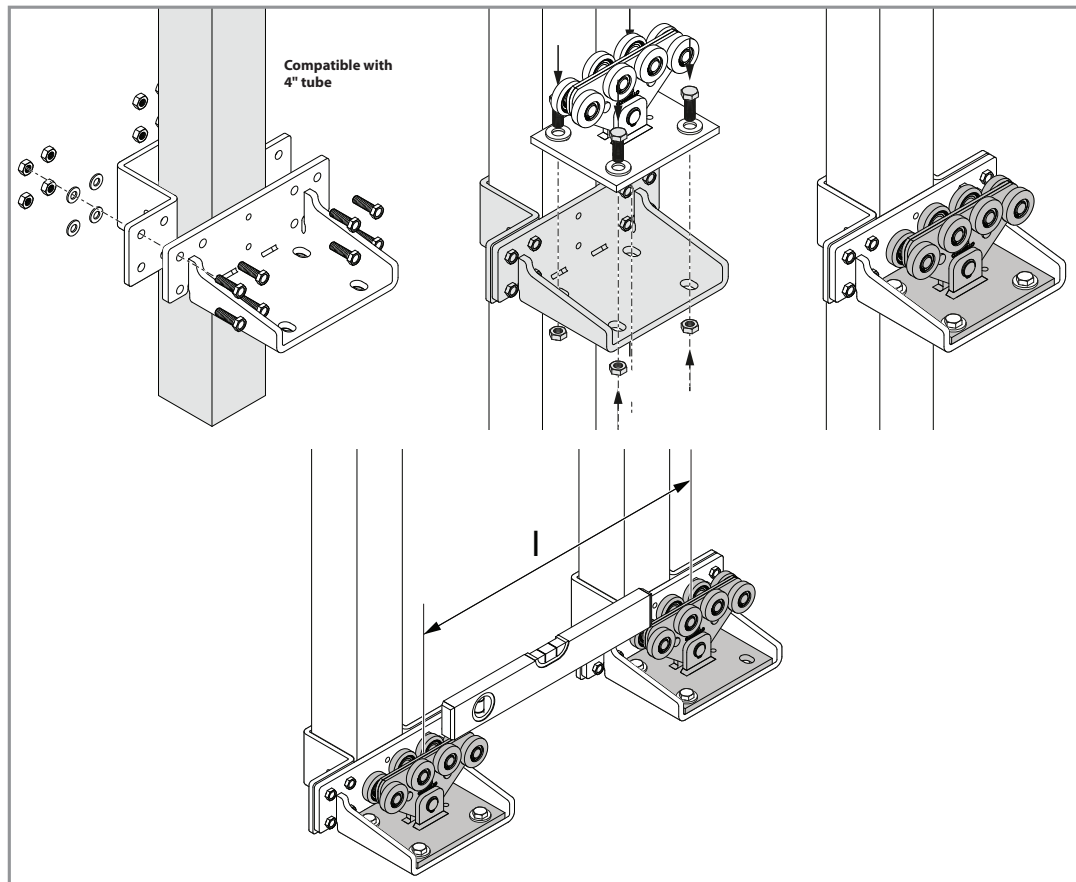
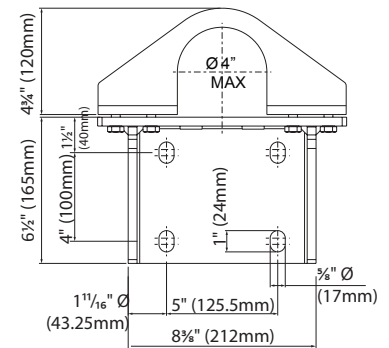
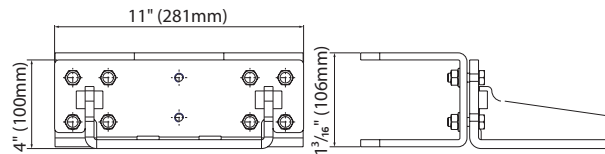

### GENERAL INSTALLATION GUIDELINES:

No cement pad is required, but we recommend that each cement embedded post have a minimum hole diameter of 16" and a minimum depth of 48".